

EMC-KT | EMC cable grommets

for shield diameters 2 - 33 mm

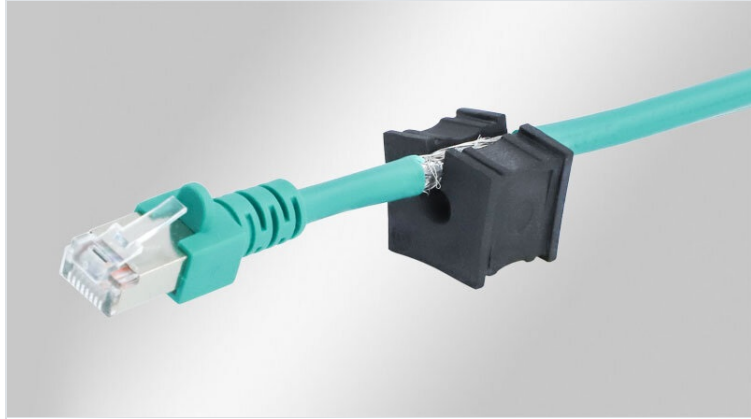

The cable grommets type EMC-KT are made of a very conductive elastomer. Thus, disturbances are dissipated from the cable shield directly via the grommet, the frame and the flat gasket. This ensures full-area protection against field-bound interference!

Suitable for:

- [EMC-KEL-U cable entry frames](#)
- [EMC-KEL-DS cable entry frames](#)
- [EMC-KVT-DS cable glands](#)

The model range EMC-KT small is designed for cable diameters from 2 to 16 mm. Cable grommets EMC-KT large accept a wide range of cable diameters from 13 to 33 mm.

When using double or quadruple grommets the cable density of EMC cable entry frames and cable glands can be greatly increased.

When installing the small grommets in multiple rows, the flat sides should be facing each other.



Specifications

Material	Elastomer, conductive
Flame class	UL94-HB
Operating temperature	-30 C° to 80 C°
Properties	silicone free, halogen free

Advantages & benefits

- Contacting the cable shield over 360°
- EMC grommets made entirely from conductive elastomer
- Enable routing of pre-terminated cables through cable entry frames and split cable glands
- Available for a large range of cable diameters
- Greatly increased cable density when using double or quadruple grommets

Product types & sizes

Product Type	Part No.	EAN	Package quantity	For max. no. of cables	Colour	Length	Width	Height	Mounting height	Blank grommet	For cable type	Min. shield diam.	Max. shield diam.	Clamping range
EMC-BTK	99473	4251269319549	5		black	21 mm	21 mm	19 mm	2 mm	1				
EMC-KT 3	99460	4251269319419	5	1	black	21 mm	21 mm	19 mm	2 mm		Round cable	3 mm	4 mm	1 x 3 - 4 mm
EMC-KT 2	99459	4251269324772	5	1	black	21 mm	21 mm	19 mm	2 mm		Round cable	2 mm	3 mm	1 x 2 - 3 mm

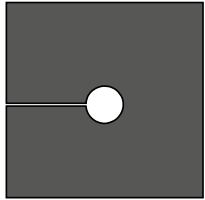
EMC-KT 4

Part No. **99461**
 EAN **4251269319426**
 Package quantity **5**
 For max. no. of cables **1**
 Colour **black**
 Length **21 mm**
 Width **21 mm**

Height **19 mm**
 Mounting height **2 mm**
 For cable type **Round cable**
 Min. shield diam. **4 mm**
 Max. shield diam. **5 mm**
 Clamping range **1 x 4 - 5 mm**

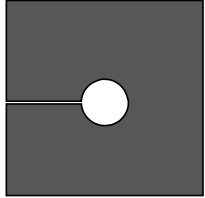
EMC-KT 5

Part No. **99462**
 EAN **4251269319433**
 Package quantity **5**
 For max. no. of cables **1**
 Colour **black**
 Length **21 mm**
 Width **21 mm**

Height **19 mm**
 Mounting height **2 mm**
 For cable type **Round cable**
 Min. shield diam. **5 mm**
 Max. shield diam. **6 mm**
 Clamping range **1 x 5 - 6 mm**

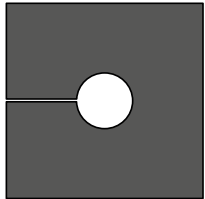
EMC-KT 6

Part No. **99463**
 EAN **4251269319440**
 Package quantity **5**
 For max. no. of cables **1**
 Colour **black**
 Length **21 mm**
 Width **21 mm**

Height **19 mm**
 Mounting height **2 mm**
 For cable type **Round cable**
 Min. shield diam. **6 mm**
 Max. shield diam. **7 mm**
 Clamping range **1 x 6 - 7 mm**

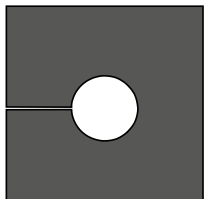
EMC-KT 7

Part No. **99464**
 EAN **4251269319457**
 Package quantity **5**
 For max. no. of cables **1**
 Colour **black**
 Length **21 mm**
 Width **21 mm**

Height **19 mm**
 Mounting height **2 mm**
 For cable type **Round cable**
 Min. shield diam. **7 mm**
 Max. shield diam. **8 mm**
 Clamping range **1 x 7 - 8 mm**

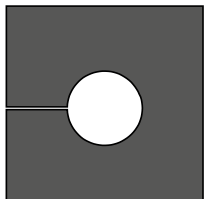
EMC-KT 8

Part No. **99465**
 EAN **4251269319464**
 Package quantity **5**
 For max. no. of cables **1**
 Colour **black**
 Length **21 mm**
 Width **21 mm**

Height **19 mm**
 Mounting height **2 mm**
 For cable type **Round cable**
 Min. shield diam. **8 mm**
 Max. shield diam. **9 mm**
 Clamping range **1 x 8 - 9 mm**

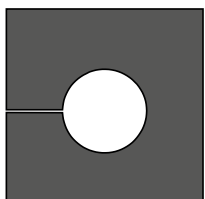
EMC-KT 9

Part No. **99466**
 EAN **4251269319471**
 Package quantity **5**
 For max. no. of cables **1**
 Colour **black**
 Length **21 mm**
 Width **21 mm**

Height **19 mm**
 Mounting height **2 mm**
 For cable type **Round cable**
 Min. shield diam. **9 mm**
 Max. shield diam. **10 mm**
 Clamping range **1 x 9 - 10 mm**

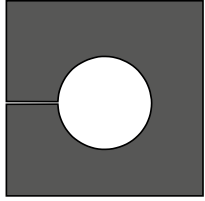
EMC-KT 10

Part No. **99467**
 EAN **4251269319488**
 Package quantity **5**
 For max. no. of cables **1**
 Colour **black**
 Length **21 mm**
 Width **21 mm**

Height **19 mm**
 Mounting height **2 mm**
 For cable type **Round cable**
 Min. shield diam. **10 mm**
 Max. shield diam. **11 mm**
 Clamping range **1 x 10 - 11 mm**

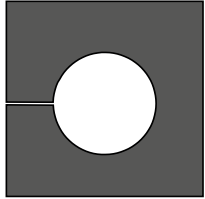
EMC-KT 11

Part No. **99468**
 EAN **4251269319495**
 Package quantity **5**
 For max. no. of cables **1**
 Colour **black**
 Length **21 mm**
 Width **21 mm**

Height **19 mm**
 Mounting height **2 mm**
 For cable type **Round cable**
 Min. shield diam. **11 mm**
 Max. shield diam. **12 mm**
 Clamping range **1 x 11 - 12 mm**

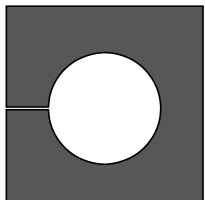
EMC-KT 12

Part No. **99469**
 EAN **4251269319501**
 Package quantity **5**
 For max. no. of cables **1**
 Colour **black**
 Length **21 mm**
 Width **21 mm**

Height **19 mm**
 Mounting height **2 mm**
 For cable type **Round cable**
 Min. shield diam. **12 mm**
 Max. shield diam. **13 mm**
 Clamping range **1 x 12 - 13 mm**

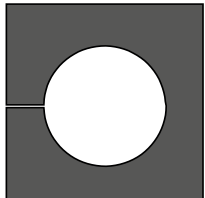
EMC-KT 13

Part No. **99470**
 EAN **4251269319518**
 Package quantity **5**
 For max. no. of cables **1**
 Colour **black**
 Length **21 mm**
 Width **21 mm**

Height **19 mm**
 Mounting height **2 mm**
 For cable type **Round cable**
 Min. shield diam. **13 mm**
 Max. shield diam. **14 mm**
 Clamping range **1 x 13 - 14 mm**

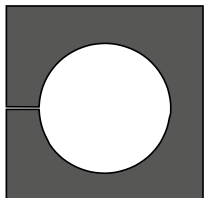
EMC-KT 14

Part No. **99471**
 EAN **4251269319525**
 Package quantity **5**
 For max. no. of cables **1**
 Colour **black**
 Length **21 mm**
 Width **21 mm**

Height **19 mm**
 Mounting height **2 mm**
 For cable type **Round cable**
 Min. shield diam. **14 mm**
 Max. shield diam. **15 mm**
 Clamping range **1 x 14 - 15 mm**

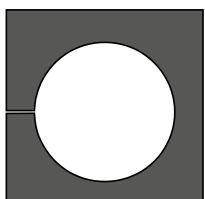
EMC-KT 15

Part No. **99472**
 EAN **4251269319532**
 Package quantity **5**
 For max. no. of cables **1**
 Colour **black**
 Length **21 mm**
 Width **21 mm**

Height **19 mm**
 Mounting height **2 mm**
 For cable type **Round cable**
 Min. shield diam. **15 mm**
 Max. shield diam. **16 mm**
 Clamping range **1 x 15 - 16 mm**

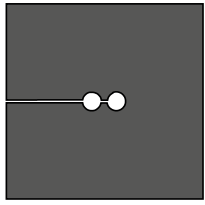
EMC-KT 2|2

Part No. **99500**
 EAN **4251269332265**
 Package quantity **5**
 For max. no. of cables **2**
 Colour **black**
 For cable type **Round cable**
 Min. shield diam. **2 mm**

Max. shield diam. **2 mm**
 Clamping range **2 x 2 - 2 mm**

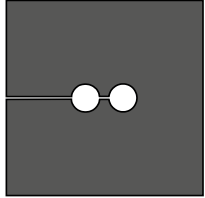
EMC-KT 2|3

Part No. **99501**
 EAN **4251269332272**
 Package quantity **5**
 For max. no. of cables **2**
 Colour **black**
 For cable type **Round cable**
 Min. shield diam. **3 mm**

Max. shield diam. **3 mm**
 Clamping range **2 x 3 - 3 mm**

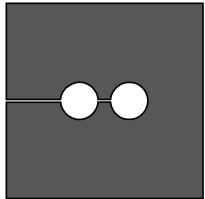
EMC-KT 2|4

Part No. **99493**
 EAN **4251269323560**
 Package quantity **5**
 For max. no. of cables **2**
 Colour **black**
 For cable type **Round cable**
 Min. shield diam. **4 mm**

Max. shield diam. **4 mm**
 Clamping range **2 x 4 - 4 mm**

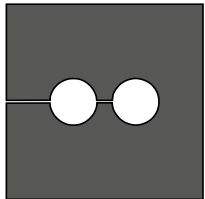
EMC-KT 2|5

Part No. **99502**
 EAN **4251269332289**
 Package quantity **5**
 For max. no. of cables **2**
 Colour **black**
 For cable type **Round cable**
 Min. shield diam. **5 mm**

Max. shield diam. **5 mm**
 Clamping range **2 x 5 - 5 mm**

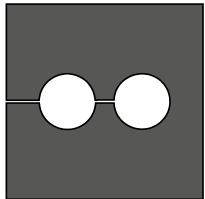
EMC-KT 2|6

Part No. **99503**
 EAN **4251269332296**
 Package quantity **5**
 For max. no. of cables **2**
 Colour **black**
 For cable type **Round cable**
 Min. shield diam. **6 mm**

Max. shield diam. **6 mm**
 Clamping range **2 x 6 - 6 mm**

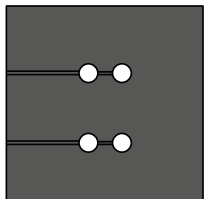
EMC-KT 4|2

Part No. **99504**
 EAN **4251269332302**
 Package quantity **5**
 For max. no. of cables **4**
 Colour **black**
 For cable type **Round cable**
 Min. shield diam. **2 mm**

Max. shield diam. **2 mm**
 Clamping range **4 x 2 - 2 mm**

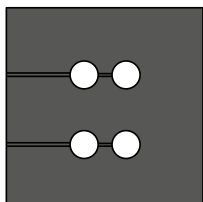
EMC-KT 4|3

Part No. **99505**
 EAN **4251269332319**
 Package quantity **5**
 For max. no. of cables **4**
 Colour **black**
 For cable type **Round cable**
 Min. shield diam. **3 mm**

Max. shield diam. **3 mm**
 Clamping range **4 x 3 - 3 mm**

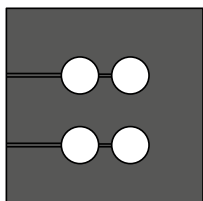
EMC-KT 4|4

Part No. **99506**
 EAN **4251269332326**
 Package quantity **5**
 For max. no. of cables **4**
 Colour **black**
 For cable type **Round cable**
 Min. shield diam. **4 mm**

Max. shield diam. **4 mm**
 Clamping range **4 x 4 - 4 mm**

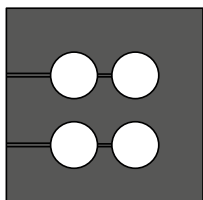
EMC-KT 4|5

Part No. **99507**
 EAN **4251269332333**
 Package quantity **5**
 For max. no. of cables **4**
 Colour **black**
 For cable type **Round cable**
 Min. shield diam. **5 mm**

Max. shield diam. **5 mm**
 Clamping range **4 x 5 - 5 mm**

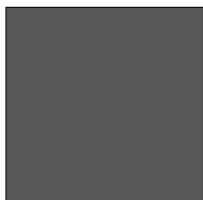
EMC-BTG

Part No. **99495**
 EAN **4251269319648**
 Package quantity **5**
 Colour **black**
 Length **41,5 mm**
 Width **42 mm**
 Height **19 mm**

Mounting height **2 mm**
 Blank grommet **1**

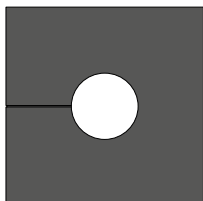
EMC-KTG 14

Part No. **99497**
 EAN **4251269324239**
 Package quantity **5**
 For max. no. of cables **1**
 Colour **black**
 Length **41,5 mm**
 Width **42 mm**

Height **19 mm**
 Mounting height **2 mm**
 For cable type **Round cable**
 Min. shield diam. **14 mm**
 Max. shield diam. **15 mm**
 Clamping range **1 x 14 - 15 mm**

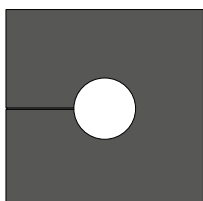
EMC-KTG 13

Part No. **99496**
 EAN **4251269324222**
 Package quantity **5**
 For max. no. of cables **1**
 Colour **black**
 Length **41,5 mm**
 Width **42 mm**

Height **19 mm**
 Mounting height **2 mm**
 For cable type **Round cable**
 Min. shield diam. **13 mm**
 Max. shield diam. **14 mm**
 Clamping range **1 x 13 - 14 mm**

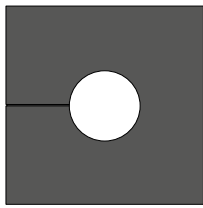
EMC-KTG 15

Part No. **99498**
 EAN **4251269324246**
 Package quantity **5**
 For max. no. of cables **1**
 Colour **black**
 Length **41,5 mm**
 Width **42 mm**

Height **19 mm**
 Mounting height **2 mm**
 For cable type **Round cable**
 Min. shield diam. **15 mm**
 Max. shield diam. **16 mm**
 Clamping range **1 x 15 - 16 mm**

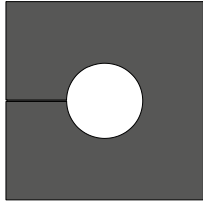
EMC-KT 16

Part No. **99475**
 EAN **4251269319556**
 Package quantity **5**
 For max. no. of cables **1**
 Colour **black**
 Length **41,5 mm**
 Width **42 mm**

Height **19 mm**
 Mounting height **2 mm**
 For cable type **Round cable**
 Min. shield diam. **16 mm**
 Max. shield diam. **17 mm**
 Clamping range **1 x 16 - 17 mm**

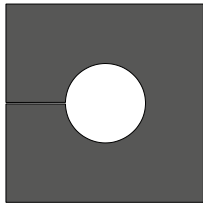
EMC-KT 17

Part No. **99476**
 EAN **4251269319563**
 Package quantity **5**
 For max. no. of cables **1**
 Colour **black**
 Length **41,5 mm**
 Width **42 mm**

Height **19 mm**
 Mounting height **2 mm**
 For cable type **Round cable**
 Min. shield diam. **17 mm**
 Max. shield diam. **18 mm**
 Clamping range **1 x 17 - 18 mm**

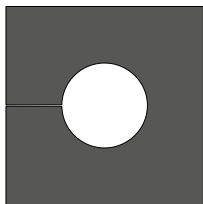
EMC-KT 18

Part No. **99477**
 EAN **4251269319570**
 Package quantity **5**
 For max. no. of cables **1**
 Colour **black**
 Length **41,5 mm**
 Width **42 mm**

Height **19 mm**
 Mounting height **2 mm**
 For cable type **Round cable**
 Min. shield diam. **18 mm**
 Max. shield diam. **19 mm**
 Clamping range **1 x 18 - 19 mm**

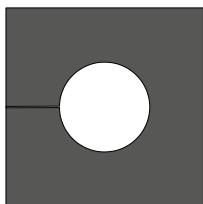
EMC-KT 19

Part No. **99478**
 EAN **4251269319587**
 Package quantity **5**
 For max. no. of cables **1**
 Colour **black**
 Length **41,5 mm**
 Width **42 mm**

Height **19 mm**
 Mounting height **2 mm**
 For cable type **Round cable**
 Min. shield diam. **19 mm**
 Max. shield diam. **20 mm**
 Clamping range **1 x 19 - 20 mm**

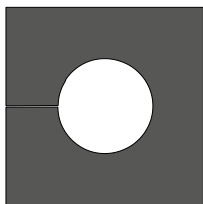
EMC-KT 20

Part No. **99479**
 EAN **4251269319594**
 Package quantity **5**
 For max. no. of cables **1**
 Colour **black**
 Length **41,5 mm**
 Width **42 mm**

Height **19 mm**
 Mounting height **2 mm**
 For cable type **Round cable**
 Min. shield diam. **20 mm**
 Max. shield diam. **21 mm**
 Clamping range **1 x 20 - 21 mm**

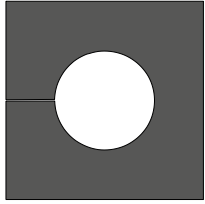
EMC-KT 21

Part No.	99480	Height	19 mm
EAN	4251269319600	Mounting height	2 mm
Package quantity	5	For cable type	Round cable
For max. no. of cables	1	Min. shield diam.	21 mm
Colour	black	Max. shield diam.	22 mm
Length	41,5 mm	Clamping range	1 x 21 - 22 mm
Width	42 mm		

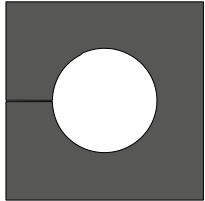
EMC-KT 22

Part No.	99481	Height	19 mm
EAN	4251269319617	Mounting height	2 mm
Package quantity	5	For cable type	Round cable
For max. no. of cables	1	Min. shield diam.	22 mm
Colour	black	Max. shield diam.	23 mm
Length	41,5 mm	Clamping range	1 x 22 - 23 mm
Width	42 mm		

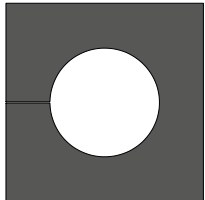
EMC-KT 23

Part No.	99482	Height	19 mm
EAN	4251269319624	Mounting height	2 mm
Package quantity	5	For cable type	Round cable
For max. no. of cables	1	Min. shield diam.	23 mm
Colour	black	Max. shield diam.	24 mm
Length	41,5 mm	Clamping range	1 x 23 - 24 mm
Width	42 mm		

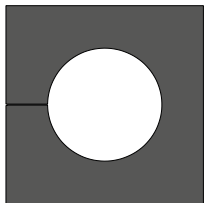
EMC-KT 24

Part No.	99483	Height	19 mm
EAN	4251269319631	Mounting height	2 mm
Package quantity	5	For cable type	Round cable
For max. no. of cables	1	Min. shield diam.	24 mm
Colour	black	Max. shield diam.	25 mm
Length	41,5 mm	Clamping range	1 x 24 - 25 mm
Width	42 mm		

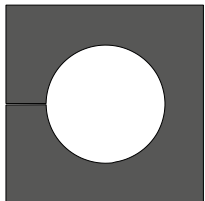
EMC-KT 25

Part No.	99484	Height	19 mm
EAN	4251269323836	Mounting height	2 mm
Package quantity	5	For cable type	Round cable
For max. no. of cables	1	Min. shield diam.	25 mm
Colour	black	Max. shield diam.	26 mm
Length	41,5 mm	Clamping range	1 x 25 - 26 mm
Width	42 mm		

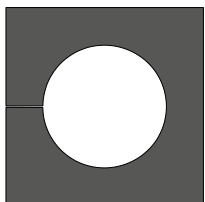
EMC-KT 26

Part No.	99485	Height	19 mm
EAN	4251269323843	Mounting height	2 mm
Package quantity	5	For cable type	Round cable
For max. no. of cables	1	Min. shield diam.	26 mm
Colour	black	Max. shield diam.	27 mm
Length	41,5 mm	Clamping range	1 x 26 - 27 mm
Width	42 mm		

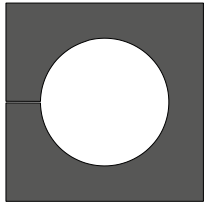
EMC-KT 27

Part No. **99486**
 EAN **4251269323850**
 Package quantity **5**
 For max. no. of cables **1**
 Colour **black**
 Length **41,5 mm**
 Width **42 mm**

Height **19 mm**
 Mounting height **2 mm**
 For cable type **Round cable**
 Min. shield diam. **27 mm**
 Max. shield diam. **28 mm**
 Clamping range **1 x 27 - 28 mm**

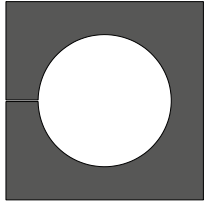
EMC-KT 28

Part No. **99487**
 EAN **4251269323867**
 Package quantity **5**
 For max. no. of cables **1**
 Colour **black**
 Length **41,5 mm**
 Width **42 mm**

Height **19 mm**
 Mounting height **2 mm**
 For cable type **Round cable**
 Min. shield diam. **28 mm**
 Max. shield diam. **29 mm**
 Clamping range **1 x 28 - 29 mm**

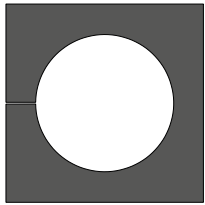
EMC-KT 29

Part No. **99488**
 EAN **4251269323874**
 Package quantity **5**
 For max. no. of cables **1**
 Colour **black**
 Length **41,5 mm**
 Width **42 mm**

Height **19 mm**
 Mounting height **2 mm**
 For cable type **Round cable**
 Min. shield diam. **29 mm**
 Max. shield diam. **30 mm**
 Clamping range **1 x 29 - 30 mm**

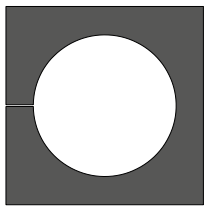
EMC-KT 30

Part No. **99489**
 EAN **4251269323881**
 Package quantity **5**
 For max. no. of cables **1**
 Colour **black**
 Length **41,5 mm**
 Width **42 mm**

Height **19 mm**
 Mounting height **2 mm**
 For cable type **Round cable**
 Min. shield diam. **30 mm**
 Max. shield diam. **31 mm**
 Clamping range **1 x 30 - 31 mm**

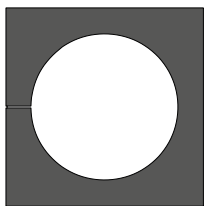
EMC-KT 31

Part No. **99490**
 EAN **4251269323898**
 Package quantity **5**
 For max. no. of cables **1**
 Colour **black**
 Length **41,5 mm**
 Width **42 mm**

Height **19 mm**
 Mounting height **2 mm**
 For cable type **Round cable**
 Min. shield diam. **31 mm**
 Max. shield diam. **32 mm**
 Clamping range **1 x 31 - 32 mm**

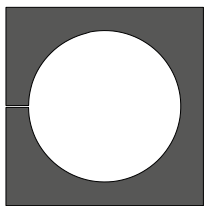
EMC-KT 32

Part No. **99491**
 EAN **4251269323904**
 Package quantity **5**
 For max. no. of cables **1**
 Colour **black**
 Length **41,5 mm**
 Width **42 mm**

Height **19 mm**
 Mounting height **2 mm**
 For cable type **Round cable**
 Min. shield diam. **32 mm**
 Max. shield diam. **33 mm**
 Clamping range **1 x 32 - 33 mm**

