

KVT-W90 | Split 90° cable gland

for cables with connectors, M32/M50 / IP54



The split KVT-W90 cable glands are used to insert and seal pre-terminated cables at a 90° angle. But also electric, pneumatic or hydraulic lines without terminals or connectors as well as corrugated conduits can be easily routed (e.g. into control panels, enclosures or machinery) and sealed with IP54.

In particular, the KVT 50-W90 is perfectly suited to hold corrugated or smooth hoses. A large number of cable entry grommets is available to the user. By using [multi-hole grommets](#) up to 16 lines can be routed with one cable gland.

Polyamide standard locknuts as well as a sealing ring are included in the shipment. [Split locknuts](#) can be ordered separately.

IP54

C_{RU}US



HL3

EN 45545-2

ECOLAB

certified



RoHS
compliant

REACH
COMPLIANCE

Made in
Germany

Specifications

IP rating (EN 60529)	IP54
Material	Polycarbonate
Flame class	UL94-V0, self-extinguishing
Operating temperature	-30 C° to 100 C°
Properties	halogen free, silicone free
Mounting options	Fasten with locknut

Advantages & Benefits

- Installation at an angle of 90° to the wall
- Routing of cables with and without connectors
- Warranty on pre-terminated cables remains
- Suitable for metric cut-outs
- Hexagonal locknut included in the delivery

Product types & Sizes

KVT 32-W90 gy

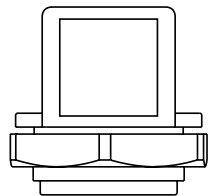

Part No.	45404
EAN	4251269311406
Package quantity	10
For max. no. of cables	4
Max. cable diameter	17 mm
Color	gray (similar RAL 7035)
Height	40 mm

Mounting height	26 mm
Cut-out size, metric	M32
Cut-out size, round	32,3 mm
Thread	M32 x 1,5
Thread length	11,5 mm
Suitable for grommets	1 x KT small

KVT 32-W90 bk

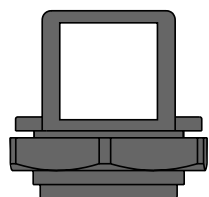

Part No.	45406
EAN	4251269311413
Package quantity	10
For max. no. of cables	4
Max. cable diameter	17 mm
Color	black
Height	40 mm

Mounting height	26 mm
Cut-out size, metric	M32
Cut-out size, round	32,3 mm
Thread	M32 x 1,5
Thread length	11,5 mm
Suitable for grommets	1 x KT small

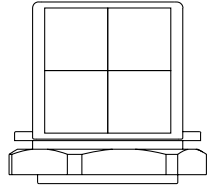
KVT 50|4-W90 gy

Part No.	45424	Mounting height	46,5 mm
EAN	4251269311444	Cut-out size, metric	M50
Package quantity	5	Cut-out size, round	50,4 mm
For max. no. of cables	16	Thread	M50 × 1,5
Max. cable diameter	17 mm	Thread length	11,5 mm
Color	gray (similar RAL 7035)	Suitable for grommets	4 x KT small
Height	61 mm		

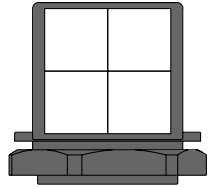
KVT 50|4-W90 bk

Part No.	45426	Mounting height	46,5 mm
EAN	4251269311451	Cut-out size, metric	M50
Package quantity	5	Cut-out size, round	50,4 mm
For max. no. of cables	16	Thread	M50 × 1,5
Max. cable diameter	17 mm	Thread length	11,5 mm
Color	black	Suitable for grommets	4 x KT small
Height	61 mm		

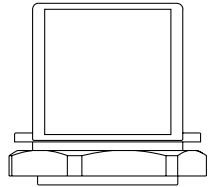
KVT 50|1-W90 gy

Part No.	45414	Mounting height	46,5 mm
EAN	4251269311420	Cut-out size, metric	M50
Package quantity	5	Cut-out size, round	50,4 mm
For max. no. of cables	1	Thread	M50 × 1,5
Max. cable diameter	35 mm	Thread length	11,5 mm
Color	gray (similar RAL 7035)	Suitable for grommets	1 x KT large
Height	61 mm		

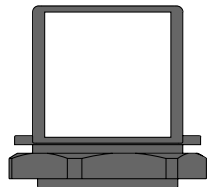
KVT 50|1-W90 bk

Part No.	45416	Mounting height	46,5 mm
EAN	4251269311437	Cut-out size, metric	M50
Package quantity	5	Cut-out size, round	50,4 mm
For max. no. of cables	1	Thread	M50 × 1,5
Max. cable diameter	35 mm	Thread length	11,5 mm
Color	black	Suitable for grommets	1 x KT large
Height	61 mm		